



# INTERCONTINENTAL.

HOTELS & RESORTS

## Fact Sheet

---

### Property Profile

InterContinental Malta redefines the meaning of elegance with its modern contemporary design, supreme comfort and impeccable service. The hotel is located in the cosmopolitan area of St. George's Bay in St. Julian's, just seven kilometers from the historical capital Valletta and twelve kilometers away from Malta International Airport. It offers supreme comfort, impeccable service and an array of leisure facilities, complimented by a menu of fine restaurants and bars, providing a genuine experience renowned worldwide. At InterContinental Malta all designer-led rooms are superbly furnished, having all the comforts expected of a luxury hotel, equipped with en-suite bathrooms, separate shower and bath. The hotel's top three floors house the Club InterContinental rooms and suites, supported by the Club InterContinental Lounge. This lounge offers an exclusive venue where a range of individual services are offered to our club guests. Richly endowed on the leisure front the hotel boasts a 47 meter panoramic lagoon styled swimming pool, set in landscaped gardens, with stunning views. The Beauty Studio offers extensive wellness and beauty treatments, whilst a 17 metre long indoor pool is the centerpiece of the hotel's Cynergi Fitness Centre, the most extensive spa on the Islands. The InterContinental Beach Club, conveniently situated only 143 meters away from the hotel, incorporates an extensive array of amenities, including an exclusive beach area set aside for guests' personal use. There are 22 separate meeting rooms, providing a variety of capacities, in various seating arrangements for a variety of events. Conference space totals 5,000 sqm, including the Eden Arena.



## Hotel Rooms

### Deluxe Rooms

Deluxe rooms have luxurious twin or king beds with spacious bathrooms having a bathtub and separate shower. Relax and unwind on your private balcony or comfortable armchair, with a drink from the mini-bar or warm beverage, which can be prepared with in-room coffee and tea making facilities. For the discerning traveller a hairdryer, iron and board and safe are available including state of the art connectivity with cable / satellite TV, WIFI and broadband and phone with voice mail.

### Club Rooms

Located on the 13th, 14th and 15th floors, Club Rooms have splendid panoramic views and additional bath and bedrooms amenities. Guests staying in Club Rooms have access to the private Club InterContinental Lounge, a world of luxury, splendor and subtle elegance married with stunning views across the Island and Mediterranean.

### Club Suites

Club Suites are also located on top executive three floors and invite you to the ultimate comfort and luxury with a spacious separate living area with sofa, armchair, TV unit and stereo sound system. These rooms have high-speed broadband and WIFI connections. Club suites have upgraded facilities and have access to the private lounge which sports stunning views across the Island and the Mediterranean.

### Presidential Suites

The Presidential Suite is located on the 15th floor with a terrace overlooking stunning view of the Island. This suite measures 120 sqm comprising of 60 sqm king size bedroom including an en suite bathroom with a Jacuzzi and a separate shower and an option for an interconnecting room. Superbly furnished together with a separate parlor, a baby grand piano, dining room with part serving area, plasma TV and stereo as well as WIFI and broadband connection are the order of the day.

## Restaurants, Bars and Lounges



### Paranga

InterContinental Beach Club's stylish restaurant Paranga, is definitely the place to wine and dine at. Paranga is set on a teak deck at the water's edge, with the sea spread beneath your eyes in one of nature's most calming sights, giving you that wonderful sense of well-being. The menu at Paranga offers an original mixture of Mediterranean elements and the selection of dishes accommodate all tastes including a feast of freshly grilled fish, marinated meats, vegetables, refreshing salads, innovative pasta dishes and much more - all guaranteed to awaken the

senses! The Bay View Terrace boasts a spacious terrace overlooking the bay which serves an Al Fresco type menu. What more could you ask for? What is more idyllic than consuming a delicious dinner whilst taking in the sight, sound and scent of the sea below?



### Paranga Lido

One of the good things about Paranga, is the luxury to choose to have a casual and light meal with refreshing salads, mouthwatering pasta dishes or pizzas with friends and family at the Paranga Lido. Whatever you chose you are bound to be more than content. Paranga Lido - an all day dining restaurant that fits into your leisurely schedule during those hot summer months!



### Absolut Vodka Bar

The Absolut Vodka Bar at Paranga offers the perfect place to watch the sun go down in style, with a classic Vodka Sundowner to wind down the evening. Besides a full range of wines, spirits and non-alcoholic beverages, there is the opportunity to enjoy a selected range of Absolut Vodka flavours, such as Absolut Peppar, Absolut Citron, Absolut Mandrin, and Absolut Kurant. Absolut Vodkas can be drunk neat or on the rocks, and also work perfectly as a mixer for delicious cocktails. The Absolut Vodka Bar is also open everyday throughout the day during summer.



### Intercontinental Beach Club

InterContinental Beach Club is conveniently located only 143 meters away from the hotel and incorporates an extensive array of amenities, including an exclusive sandy beach area set aside for guests' personal use. Entrance to the InterContinental Beach Club is free for hotel guests and sun relaxers, umbrellas, beach towels and showers are also provided free-of-charge. Waiter service is available on the beach and we aim at making our guests' experience a leisurely and comfortable one. An array of water-sports and scuba-diving activities are also offered.



### Eastern Breeze

Eastern Breeze is a cosmopolitan, contemporary Asian fusion restaurant and its menu and decor makes a pleasant alternative to the usual Eastern fare and flair. The menu at the Eastern Breeze features an exotic fusion of Asian flavours using the best plain food signature products from the East. For those Sushi lovers, authentic Japanese dishes are also on the menu and are prepared from an open stage kitchen in full view of all guests.



### Harruba

HARRUBA RESTAURANT where a stunning array of magnificent food will tempt even the most jaded of palates. Harruba features the best available seasonal and international daily buffet dinners with different themes every evening: - Monday: French Cuisine; Tuesday: Italian Spread; Wednesday: Asian Flavors; Thursday: Caribbean Dream; Friday: Jazz and Dine; Saturday: Seafood Saturdays; Sunday: International Tastes. A full Buffet Breakfast is served from 06.30 to 10.30 hrs and buffet dinners are served from 19.00 to 22.30 hrs.



### Soprano

Soprano is set under the atrium and offers a seasonal all day dining a la carte experience capturing the essence of Italian and Mediterranean cuisine. Open from Monday to Sunday from 19.00 to 23.00 hrs with an open-theatre kitchen.



### Lobby Bar

The ideal meeting place, serving an array of refreshing drinks, cocktails and afternoon teas as well as delicious pastries, a lunch salad buffet and light meals.



### Carissa

The new look at Carissa is not just a bar, but somewhere you can eat a good meal in a trendy, comfortable atmosphere. Carissa is visually vibrant yet pleasantly quiet - a relaxing ambience in which to choose from a selection of pasta, pizza, antipasto, simple meat and fish dishes.



### Al fresco

Enjoy a breath of fresh air at Al Fresco Restaurant, situated in the midst of the lush gardens at InterContinental Malta. Al Fresco offers an exclusive a la carte service in a romantic ambience with a large selection of Mediterranean and Maltese dishes as well as fresh seafood, which Chef Jonathan Lee will be pleased to prepare to your liking. This restaurant is the ultimate moonlight dining experience throughout the starry summer nights.



### Narcis

Enjoy a light snack or a sizzling grill off the BBQ with refreshing drinks or cocktails at Narcis, in the idyllic setting of the pool area surrounded by lush gardens and stunning views.

## Conference Facilities

InterContinental Malta, is fast becoming one of Europe's leading conference venues. Centrally located in the prime area of St. George's Bay and within walking distance of some of Malta's finest shopping and entertainment venues, the 451 room contemporary designed hotel is just 20 minutes from Malta International Airport and only 7kms from Valletta, Malta's historic capital.

### Eden Arena

Situated within the heart of St. George's Bay, the Eden Arena is the ideal place for your entire medium to large venue needs. The Eden Arena offers the largest uninterrupted floor area, as well as significant amount of non-core space, in this area. The size of the venue and the ability to segment areas of the floor space allows ultimate versatility for different styles of events, from trade shows and exhibitions, launches and conferences, to receptions and large parties, themed events and gala dinners.



## Cettina De Cesare Meeting Room

Located on level 2 with six hundred square metres of floor area and the possibility of dividing this room into three separate rooms makes CDC an ideal and most versatile venue. Having a capacity of 770 in theatre style, in built simultaneous translation booths and extensive foyer areas this ballroom is ideal for both meetings and events. Drop down screens, telephone/internet points as well as an audio facility are available.

## Saturn Meeting Room

Two meetings in one or one in two. Saturn, located on level 2 can be divided to accommodate 90 in theatre style when used as a whole or 42 in theatre style when used as two rooms. Drop down screen, telephone / internet points as well as audio facility are available as well as adjacent foyer areas.

## Jupiter Meeting Room

Located just metres from the main ballroom on level 2, Jupiter can accommodate 90 in theatre style and is also ideal to also be used as an office due to its location to Cettina De Cesare. Drop down screen, telephone/internet points as well as audio facility are available as well as adjacent foyer areas.



## Maurice De Cesare Meeting Room

Located on level 1 with just under three hundred square metres of floor area and the possibility of dividing this room into three separate rooms make MDC an ideal and most versatile venue for meetings from 100 to 200 in theatre style. Drop down screen, telephone/internet points, an audio facility are available as well as adjacent foyer areas.

## Neptune Meeting Room

Located on level 1, Neptune 1 & Neptune 2 can be used independently or combined. These syndicate rooms can accommodate 90 in theatre style when used as a whole or 42 in each when used as two rooms. Drop down screen, telephone/internet points, audio facility as well as adjacent foyer areas are available.

Level 1



## Palm Suite

Just off the hotel's central and landscaped gardens is the Palm Suite. The perfect venue to celebrate that special occasion in five star luxury with superb service and catering, be it a reception for 180, a banquet for 140 or a corporate launch. There are a variety of menus for lunches or dinners or cocktail receptions from which to choose from and we can tailor make your event according to your taste, budget and special requirements.

## Odyssey

Situated on level 5, Odyssey is ideal as a breakout room or boardroom meeting for 12 persons, theatre set up for 20 or for private interviews.

## Apollo

Situated on level 5, Apollo is ideal as a breakout room or boardroom meeting for 12 persons, theatre set up for 20 or for private interviews.

## Mercury

Situated on level 5, Mercury is ideal as a breakout room or boardroom meeting for 12 persons, theatre set up for 20 or for private interviews.

## Level 5

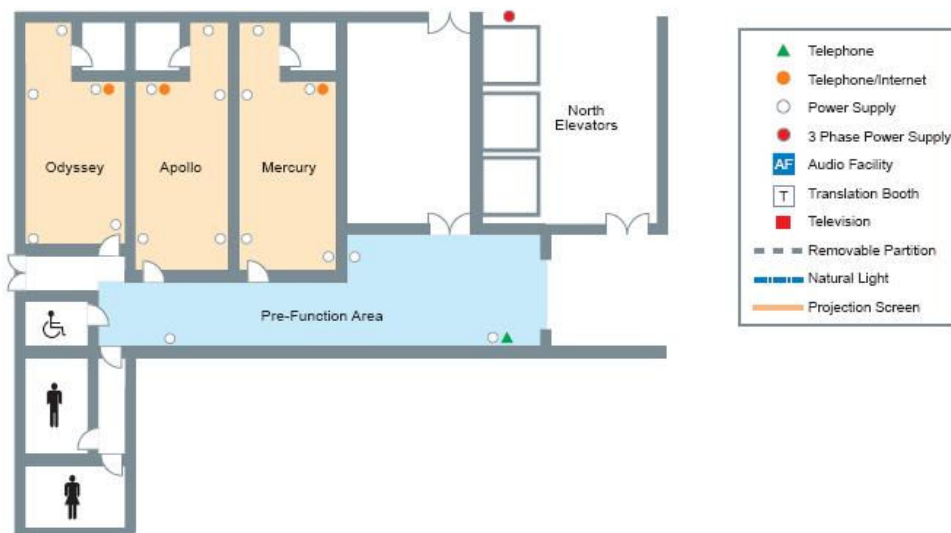

## Mars

Situated on level 8 and having natural daylight, Mars is ideal for 85 in theatre and 40 in classroom setups.

## Venus

Situated on level 8 and having natural daylight, Venus 1 & 2 can be used as one or divided into two.

## Level 8

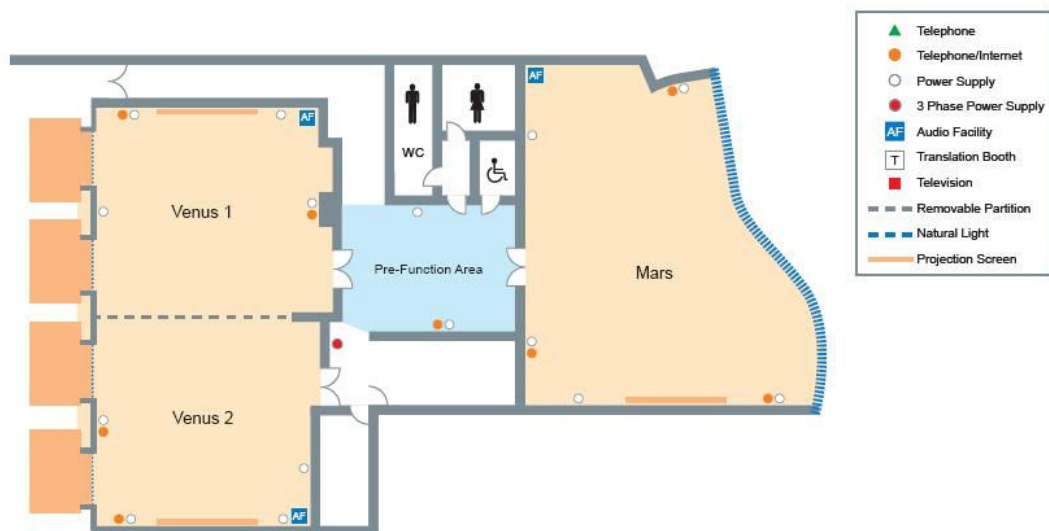

## Conference Centre Capacity Chart:

	Theatre	Classroom	Recept	Banquet	Cabaret	UShape	Boardroom	Area m <sup>2</sup>
<b>Eden Arena</b>	1700	1100	3500	1000	600	-	-	1660
<b>Cettina</b>	770	420	1000	500	270	115	115	600
<b>Saturn</b>	90	45	140	70	40	30	30	116
<b>Jupiter</b>	90	50	100	50	24	18	24	76
<b>Maurice</b>	220	125	330	210	110	100	60	299
<b>Neptune</b>	110	64	160	100	50	36	48	137
<b>Palm Suit</b>	150	90	180	140	60	30	-	375
<b>Odyssey</b>	20	12	25	-	15	10	12	30
<b>Apollo</b>	20	12	25	-	15	10	12	28
<b>Mercury</b>	20	12	25	-	15	10	12	30
<b>Mars</b>	85	40	115	60	30	24	24	139
<b>Venus</b>	65	26	90	45	20	16	15	62